

# Notes:

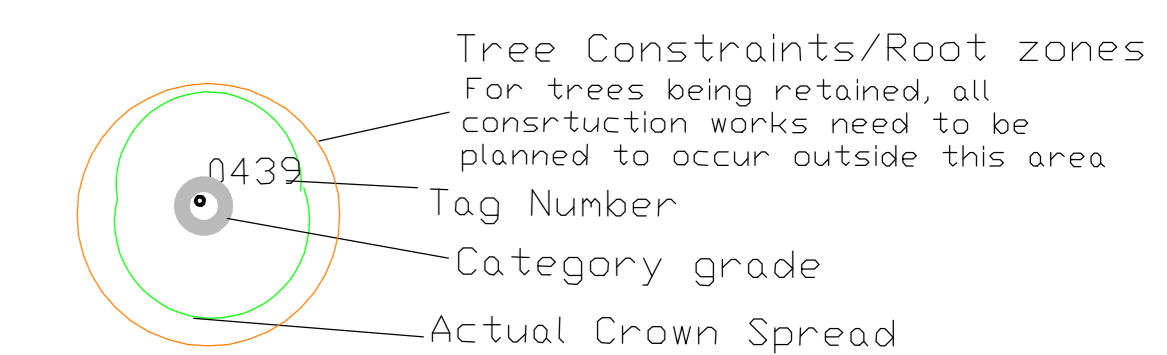

BS5837: 2012 - Category Retention Rating

- **Category U Trees-**  
Trees in such a condition that any existing value would be lost within 10 years or being recommended for removal sound arboricultural practice.
- **Category A Trees**  
Trees of high quality/value with a min. of 40 years life expectancy.
- **Category B Trees**  
Trees of moderate quality/value with a min. of 20 years life expectancy.
- **Category C Trees**  
Trees of low quality/value with a min. of 10 years life expectancy.  
Sub Categories  
1- Mainly Arboricultural values  
2 - Mainly Landscape value  
3 - Mainly cultural and conservation values.

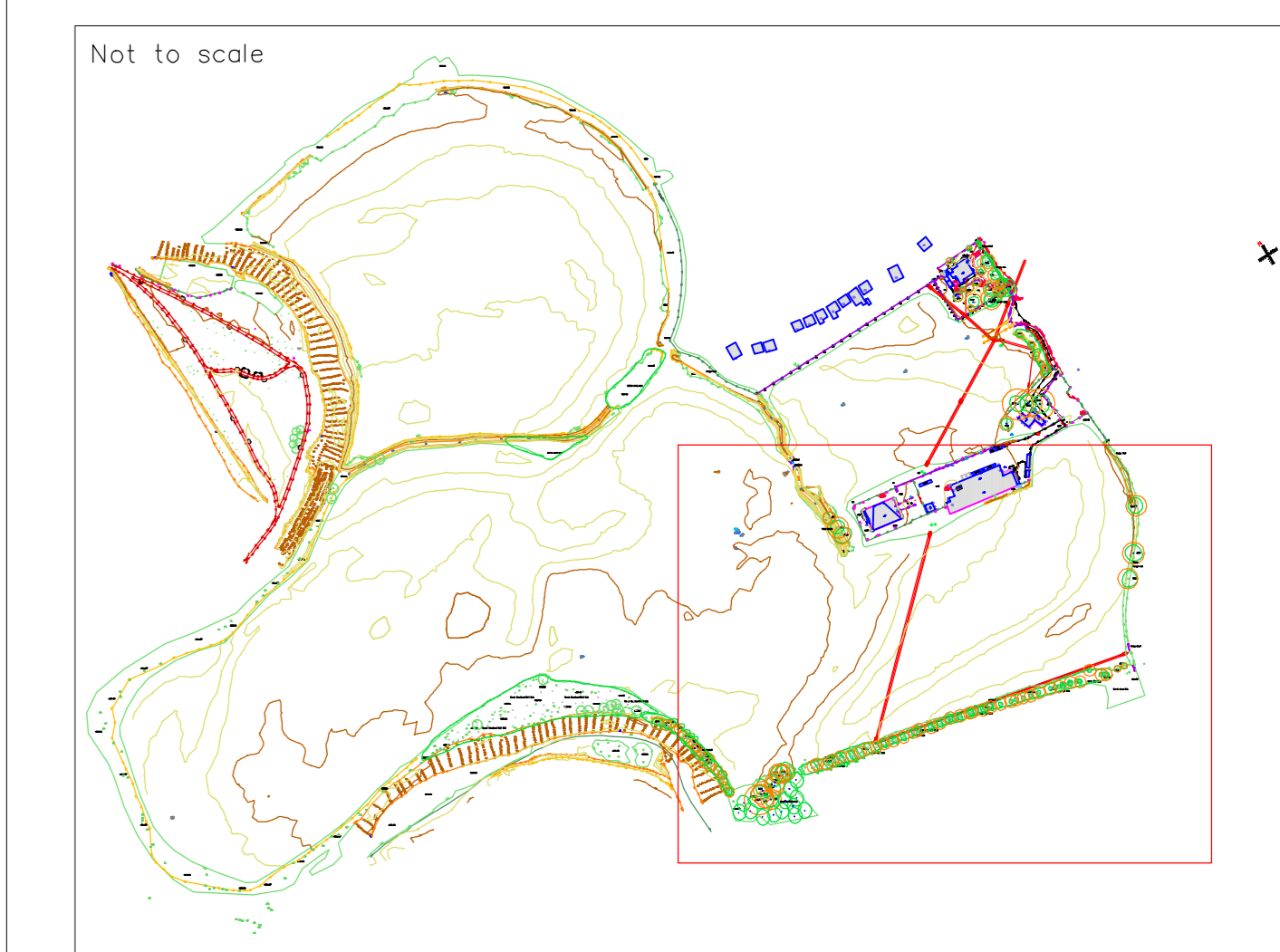
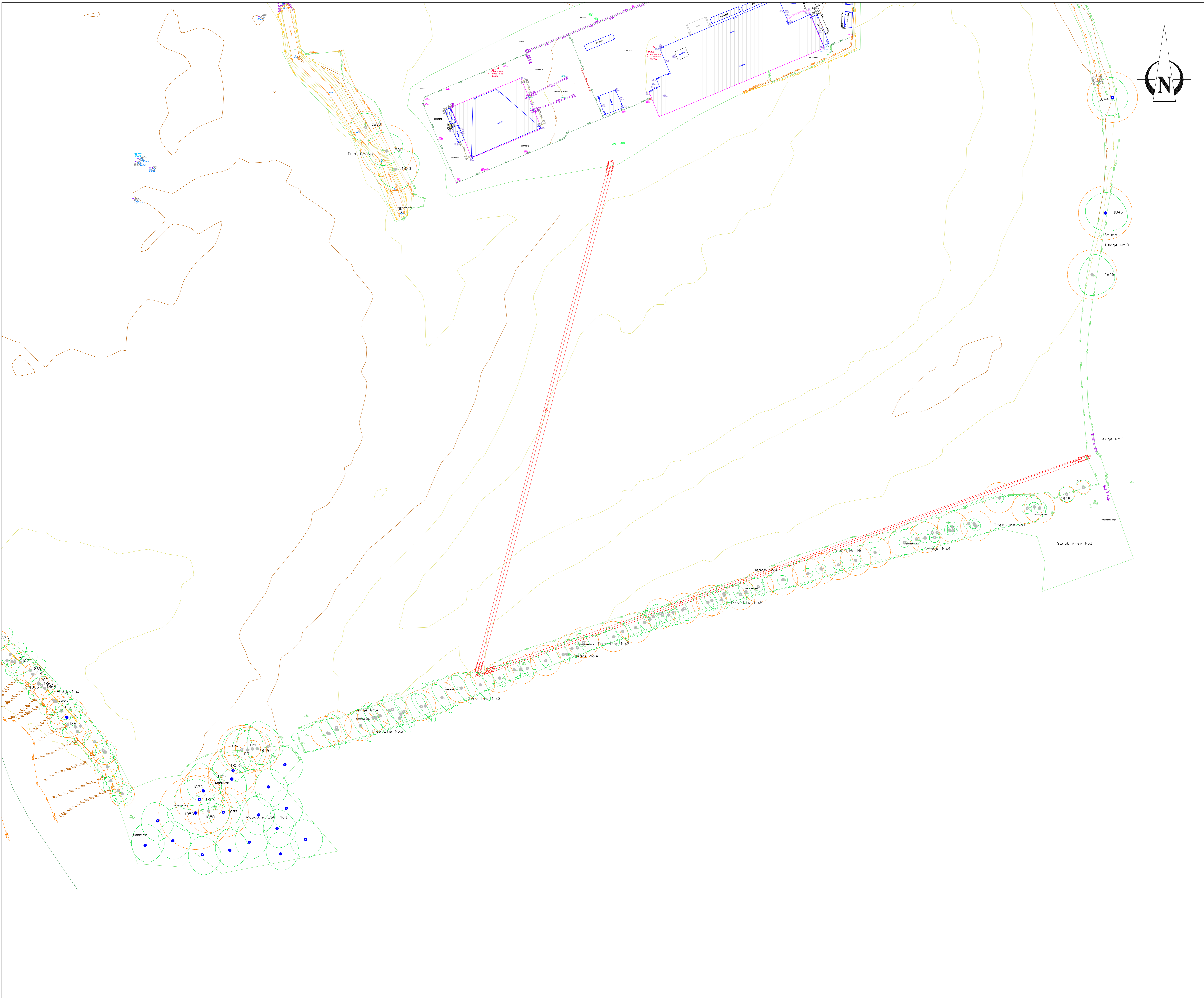
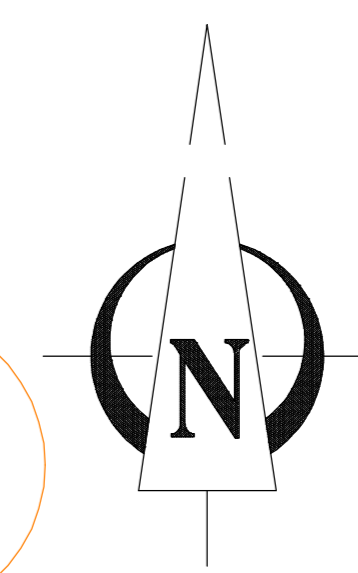

**ARBORIST ASSOCIATES LTD.**  
 94 BALLYBAWN COTTAGES, ENNISKERRY, CO. WICKLOW  
 TEL: 01-2742011 / 087-2629589

**TITLE:** Tree Constraints Plan

**Site:** Great Connell SHD, Newbridge, Co. Kildare

<b>DATE:</b>	Dwg No. GNB001 Part 2	Scale 1:500 @ A0
--------------	--------------------------	------------------