

EXISTING KILCULLEN-ARTHGARVAN FOUL WATER SEWER LONG SECTION

SCALE 1:250 (5x VERTICAL EXAGGERATION), DATUM 83.00mOD

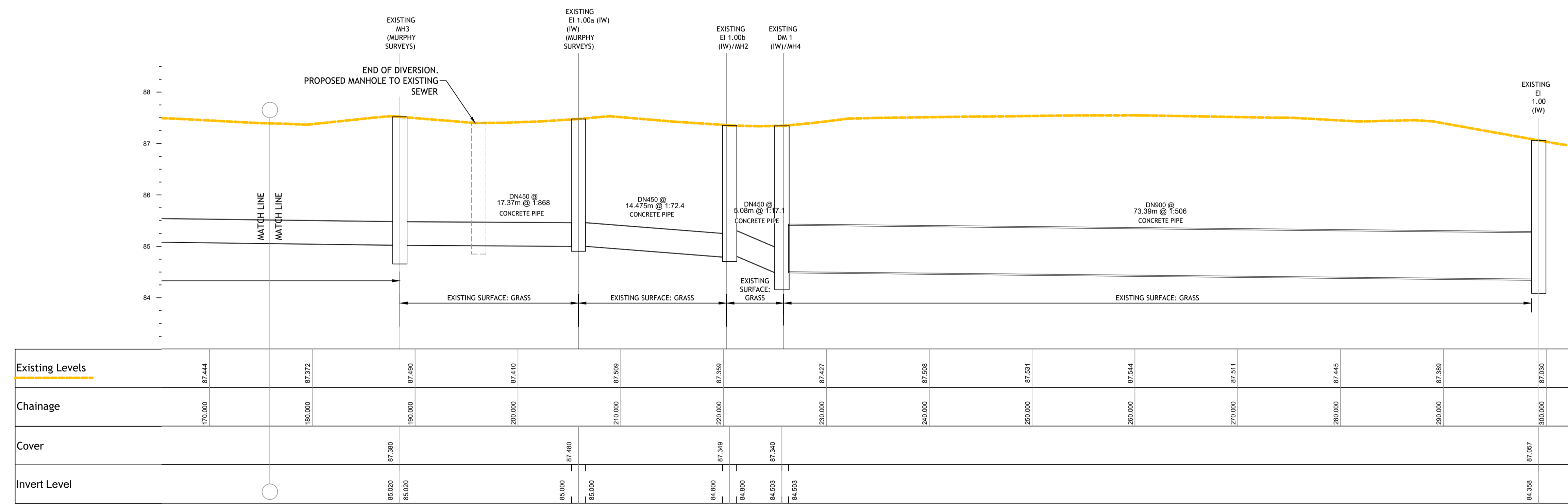

EXISTING KILCULLEN-ARTHGARVAN FOUL WATER SEWER LONG SECTION (CONT.)

SCALE 1:250 (5x VERTICAL EXAGGERATION), DATUM 83.00mOD

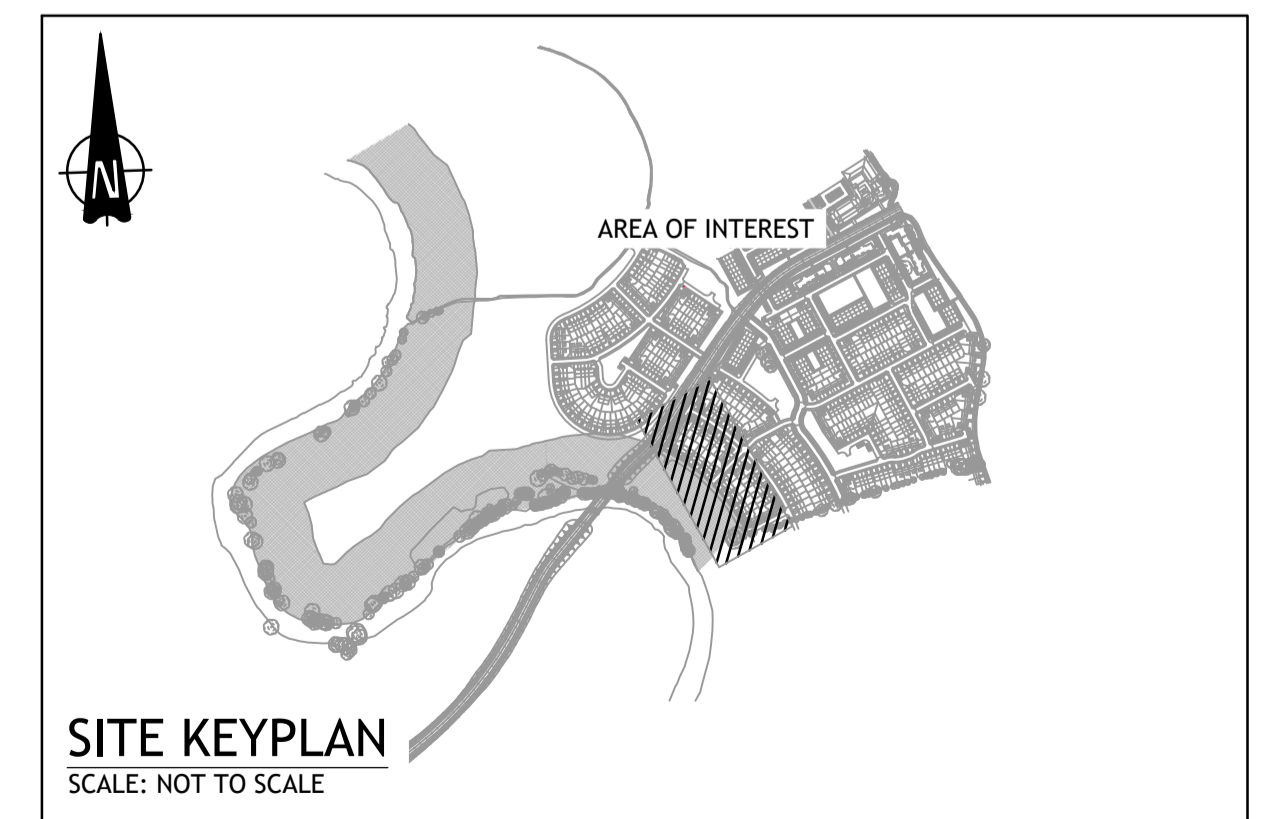

© PUNCH Consulting Engineers
This drawing and any design hereon is the copyright of the Consultants and must not be reproduced without their written consent. All drawings remain the property of the Consultants. Figured dimension only to be taken from this drawing. Consultants to be informed immediately of any discrepancies before work proceeds.



Rev	Amendment	By	Date	Rev	Amendment	By	Date	Client:
C01	ISSUE FOR DIVERSION APPLICATION	IBS	2022-02-25					
C02	ISSUE FOR DIVERSION APPLICATION	IBS	2022-03-09					
C03	ISSUED FOR PLANNING	IBS	2022-03-23					

PUNCH
consulting engineers
Dublin | Limerick | Cork | Galway | Glasgow

Project: GREAT CONNELL SHD, NEWBRIDGE			
Title: PROPOSED DIVERSION OF KILCULLEN-ARTHGARVAN FOUL WATER SEWER - LONG SECTIONS			
Drawn: IBS	Date drawn: AUGUST 2021	Technician Check: PJM	Engineer Check: SOC
Project No: 19229	Model Ref: 192229-PUNCH-XX-XX-M2-C-0130	Drawing Status: A0 PLANNING	Approved: LB
Scale @ A1: 1:500	Document Ref: 192229-PUNCH-XX-XX-DR-C-0131	Revision No: C03	

97 Henry Street, Limerick, V94 YC2H
t +353 61 221 200 | w punchconsulting.com